

# TO LET

**Rostrevor Gardens, Hayes, UB3 1AH**  
**£1,800**

**DBK**  
ESTATE AGENTS

- Available Immediately
- Recently Refurbished Semi-Detached Home
- Two Double Bedrooms (Master with Fitted Wardrobes)
- Open Plan Ground Floor
- Modern Fitted Kitchen
- Reception Room
- Fashionable Family Bathroom
- Large Rear Garden with Side Gated Access
- Front Garden with Off Street Parking
- Walking Distance to Hayes & Harlington Station

## THE PROPERTY

Available Immediately, this recently refurbished home offers modern living in a convenient location.

The property features two double bedrooms, including a master bedroom with fitted wardrobes, and an open plan ground floor. The modern fitted kitchen flows into a welcoming reception room, while the fashionable family bathroom adds a stylish touch to the first floor.

Outside, there is a large rear garden with side gated access, ideal for outdoor enjoyment, and a front garden that provides off-street parking.

Hayes is a thriving town with its excellent transport links, including Hayes & Harlington Station with access to the high-speed Crossrail (Elizabeth Line) making commuting to Central London, Heathrow Airport and other key locations quick and easy. The area boasts great shopping and dining options, with Lombardy Retail Park and nearby Uxbridge Town Centre offering a variety of amenities. Popular with families, the town is home to well-regarded schools and offers easy access to major road networks like the M4 and A40.

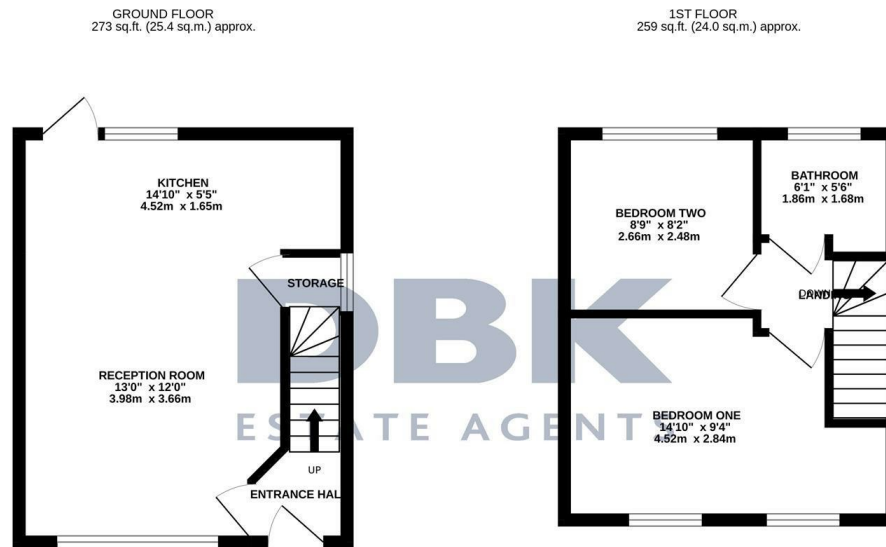

TOTAL FLOOR AREA : 532 sq.ft. (49.4 sq.m.) approx.

Whilst every attempt has been made to ensure the accuracy of the floorplan contained here, measurements of doors, windows, rooms and any other items are approximate and no responsibility is taken for any error, omission or mis-statement. This plan is for illustrative purposes only and should be used as such by any prospective purchaser. The services, systems and appliances shown have not been tested and no guarantee as to their operability or efficiency can be given.

Made with Metropix ©2025